

## Product information

## ATEX A-H4.1 / ATEX A-H4.2

# Switching heads

## ATEX A-H4.1

## ATEX A-H4.2

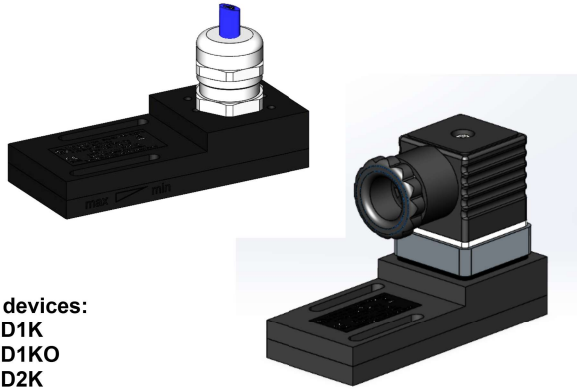

### For devices:

- HD1K
- HD1KO
- HD2K
- HD2KO
- MR1
- HR2

## Characteristics

Intrinsically safe switching head with reed switch and ATEX approval BVS 03 ATEX E390 X for the HD1/HD2/MR1/HR2 device series for use in intrinsically safe circuits.

## Technical data

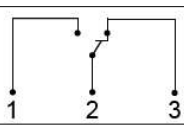
<b>Switch</b>	reed contact
<b>Media temperature</b>	-20...+120 °C
<b>Ambient temperature</b>	-20...+50 °C
<b>Electr. connection</b>	ATEX A-H4.1: cable blue, 3-wire, numbered length 2.5 m or 5 m  ATEX A-H4.2: device connector DIN EN 175301-803 (form A) for cable diameter 6-11 mm according DIN EN 60079-14, VDE 0165 Part 1, wire gauge max. 1.5 mm <sup>2</sup>
<b>Wiring diagram</b>	SPDT no. 0.213 
<b>Switching voltage</b>	max. 30 V
<b>Switching current</b>	max. 1 A
<b>Internal capacity</b>	negligible
<b>Internal inductivity</b>	negligible
<b>Housing material</b>	Plastic
<b>Protection class</b>	IP 65 according to industrial standard
<b>Weight</b>	ca. 0.1 kg
<b>Labeling</b>	I M1 Ex ia I Ma II 1G Ex ia IIC T4 Ga II 1D Ex ia IIC T <sub>200</sub> 135°C Da

## Dimensions

### ATEX A-H4.1

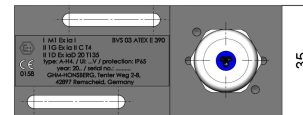
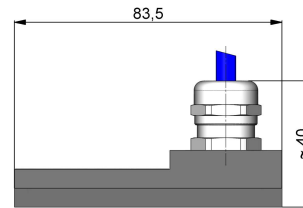

### ATEX A-H4.2

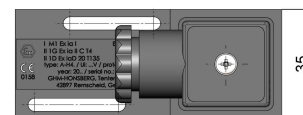
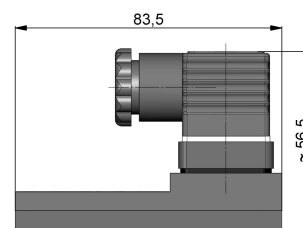

## Instructions for handling and operation

- For use only in intrinsically safe circuits – provide suitable isolating amplifiers
- Cable lengths max. 5 m
- It must be ensured that the specified values for voltage and current are not exceeded.
- A load must be connected in series when connecting the switch.
- The electrical specifications apply to resistive loads. Capacitive, inductive, and lamp loads must be operated with protective circuitry.

### When used with HD1KO / HD2KO

- The display contains plastic parts - do not open in an explosive atmosphere.

## Adjustment

In the event of a required adjustment of the switching value, the switching head can be adjusted via a longitudinal adjustment. Upon reaching the switching value, the switching unit is fixed using a fastening screw.

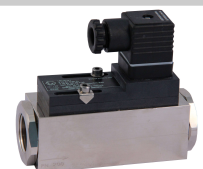

## Order information

The basic device (e.g. HD1K-015GM005A) is ordered plus switching head ATEX A-H4.2.

Art. no.	Order designation	Version
489133	ATEX A-H4.1-489133	with cable, length 2.5 m
489134	ATEX A-H4.1-489134	with cable, length 5 m
489135	ATEX A-H4.2-489135	device connector